

UT650E/UT850E/UT1050E
UT1500E/UT2200E

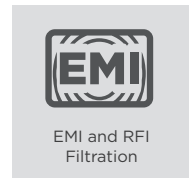

GENERATOR-COMPATIBLE TOWER UPS

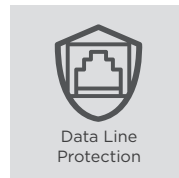
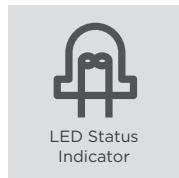
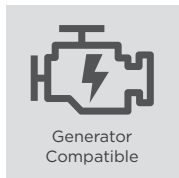
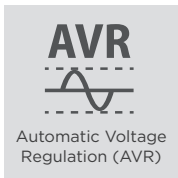
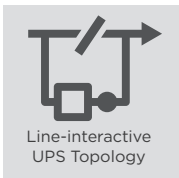

The compact UPS compatible with generators to provide power protection

Designed for home, SOHO office and office applications, the UT Series adopts line-interactive topology with Automatic Voltage Regulation (AVR) function to offer stabilized AC power output. The products are compatible with generators to extend power continuity. Other features include overload protection and configurable alarm to safeguard your devices.

APPLICATION

- Home
- Office
- SOHO Office

SERIES FEATURES

- Line-interactive UPS Topology
- Generator Compatible
- Phone/Fax/Modem/DSL/Network Protection
- Surge and Spike Protection*
- Configurable Alarm
- Tower Form Factor
- Automatic Voltage Regulation (AVR)
- LED Status Indicator
- Overload Protection
- EMI and RFI Filtration
- PowerPanel® Management Software*

*Selected Model(s)

PRODUCT CALLOUTS

1. Power On Indicator
2. Power On/Off Switch
3. Battery Capacity Indicators
4. Battery Backup Outlets
5. Battery Backup & Surge Protected Outlets
6. Communication Protection Ports RJ11/RJ45
7. Input Circuit Breaker
8. AC Input Power Cord
9. USB Port

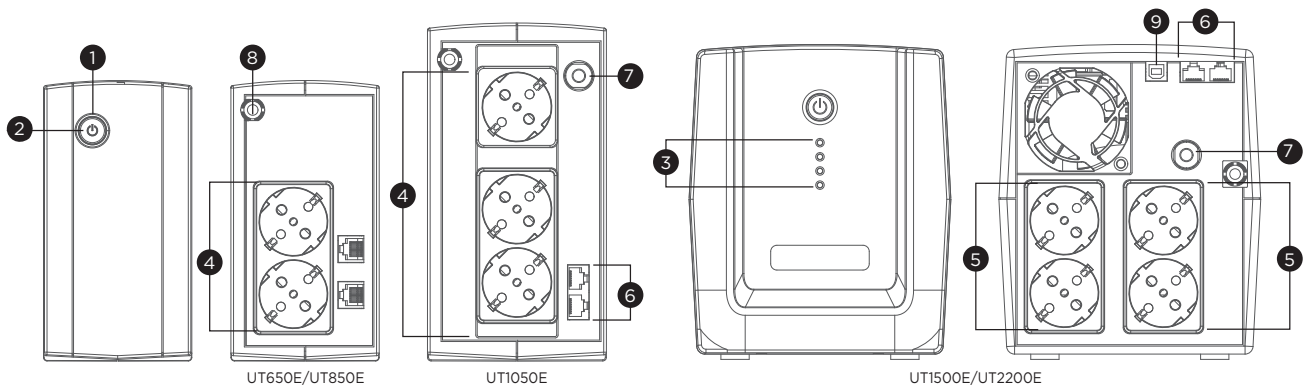



TECHNICAL SPECIFICATIONS

Model Name	UT650E	UT850E	UT1050E	UT1500E	UT2200E
General					
UPS Topology	Line-interactive	Line-interactive	Line-interactive	Line-interactive	Line-interactive
Input					
Generator Compatibility	Yes	Yes	Yes	Yes	Yes
Nominal Input Voltage (Vac)	230 ± 10%	230 ± 10%	230 ± 10%	230 ± 10%	230 ± 10%
Input Voltage Range (Vac)	165 - 290	165 - 290	165 - 290	165 - 290	165 - 290
Input Frequency (Hz)	50 ± 5, 60 ± 5	50 ± 5, 60 ± 5	50 ± 5, 60 ± 5	50 ± 10, 60 ± 10	50 ± 10, 60 ± 10
Input Frequency Detection	Auto-sensing	Auto-sensing	Auto-sensing	Auto-sensing	Auto-sensing
Rated Input Current (A)	2.95	3.86	4.77	6.82	10
Input Connector Type	Schuko	Schuko	Schuko	Schuko	Schuko
Output					
Capacity (VA)	650	850	1050	1500	2200
Capacity (Watts)	360	425	630	900	1320
On Battery Waveform	Simulated Sine Wave	Simulated Sine Wave	Simulated Sine Wave	Simulated Sine Wave	Simulated Sine Wave
On Battery Voltage(s) (Vac)	230 ± 10%	230 ± 10%	230 ± 10%	230 ± 10%	230 ± 10%
On Battery Frequency (Hz)	50 ± 1%, 60 ± 1%	50 ± 1%, 60 ± 1%	50 ± 1%, 60 ± 1%	50 ± 1%, 60 ± 1%	50 ± 1%, 60 ± 1%
Automatic Voltage Regulation (AVR)	Single Boost, Single Buck	Single Boost, Single Buck	Single Boost, Single Buck	Single Boost, Single Buck	Single Boost, Single Buck
Overload Protection	Fuse	Fuse	Circuit Breaker	Circuit Breaker	Circuit Breaker
Outlet(s) - Total	2	2	3	4	4
Outlet Type	Schuko x 2	Schuko x 2	Schuko x 3	Schuko x 4	Schuko x 4
Outlet(s) - Battery & Surge Protected	-	-	-	4	4
Outlet(s) - Battery Backup	2	2	3	-	-
Typical Transfer Time (ms)	4	4	4	4	4
Battery					
Runtime at 60W (min)	28	30	65	90	95
Runtime at 90W (min)	16	20	43	60	70
Typical Recharge Time (Hours)	8	8	8	8	8
User-replaceable	No	No	No	No	No
Battery Type	Sealed Lead-acid	Sealed Lead-acid	Sealed Lead-acid	Sealed Lead-acid	Sealed Lead-acid
Surge Protection & Filtering					
Surge Suppression (Joules)	-	-	-	125	125
EMI/RFI Filtration	Yes	Yes	Yes	Yes	Yes
Phone/Network Protection RJ11/RJ45 (Combo)	1-in, 1-out	1-in, 1-out	1-in, 1-out	1-in, 1-out	1-in, 1-out
Management & Communications					
LED Indicators	Power On, Line Mode, Battery Mode, Low Battery			Power On, Line Mode, Battery Mode, Battery Capacity, Low Battery	
HID Compliant USB Port(s)	-	-	-	1	1
Audible Alarms	Battery Mode, Low Battery, Overload, UPS Fault				
Power Management Software	-	-	-	PowerPanel® Personal Edition	
Physical					
Form Factor	Tower	Tower	Tower	Tower	Tower
Physical Size - UPS Module					
Dimensions (WxHxD) (mm.)	84 x 159 x 252	84 x 159 x 252	100 x 189 x 325	148 x 178 x 298	148 x 178 x 298
Weight (kg.)	3.8	4.2	6.9	9.1	10.8
Environmental					
Operating Temperature (°C)	0 - 40	0 - 40	0 - 40	0 - 40	0 - 40
Operating Relative Humidity (Non-condensing) (%)	0 - 90	0 - 90	0 - 90	0 - 90	0 - 90
Online Thermal Dissipation (BTU/hr)	40	40	45	102	170
Certifications					
Certifications*	CE	CE	CE	CE	CE
RoHS	Yes	Yes	Yes	Yes	Yes

*Certifications may vary according to different regions. Visit www.cyberpower.com for more information.
#All specifications are subject to change without notice.

